

1 Holdenbury House

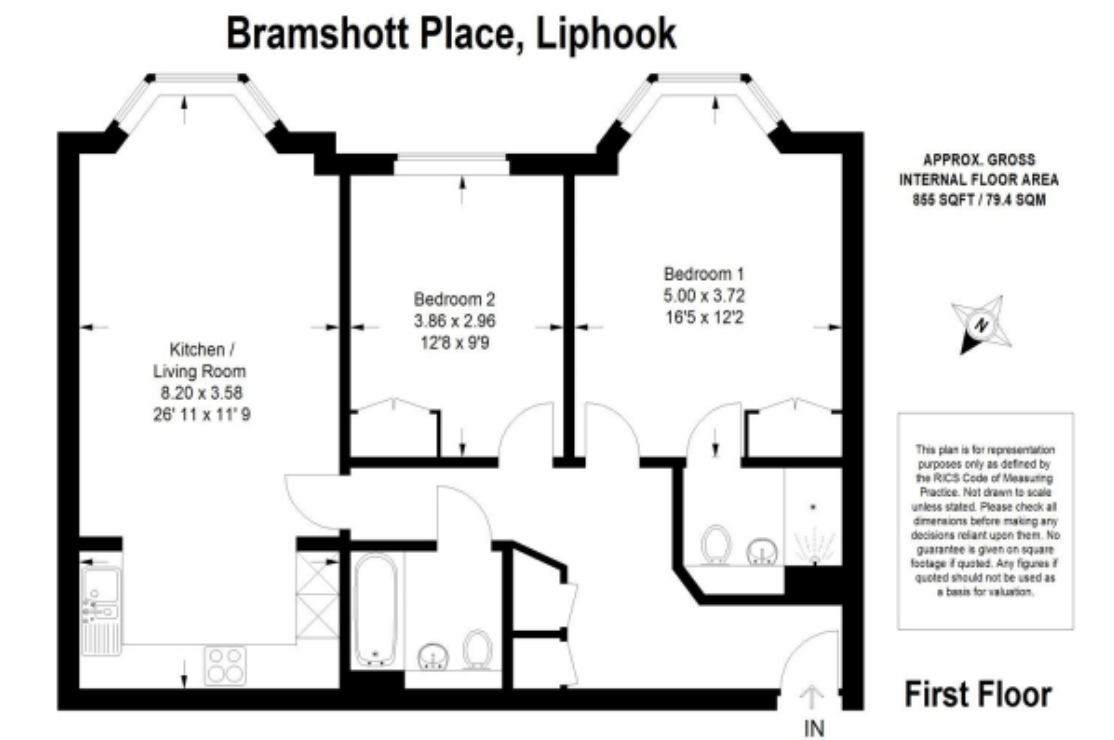

Price: £POA*, First floor

Internal measurements: 852sq ft

Kitchen/Living Room	26' 11" x 11' 9"	8,200 x 3,580mm
Bedroom 1	16' 5" x 12' 3"	5,000 x 3,720mm
Bedroom 2	12' 8" x 9' 9"	3,860 x 2,960mm

Apart from the fixtures and fittings described, the homes are unfurnished.

* Based on a 125-year lease, and subject to service charge, event fees and ground rent. Please ask for further information.

Version 3 - 19/10/2018



PLEASE NOTE: Images are for illustrative purposes only, Rooms shown may not be representative of this property.